



MIDWEST CABINET DESIGN

Email: cabinetdesign@midwestfloors.com

Phone: (801) 975-6125 Fax: (801) 990-6580

CABINET DESIGN FORM

DEALER NAME:

JOB NAME:

DATE:

CONTACT:

PHONE:

EMAIL OR FAX:

PROJECT INFORMATION

WOOD SPECIES & ASSEMBLY

SHAKER KNOTTY ALDER - KODIAK	ASSEMBLED
WINTER HAVEN BIRCH	UNASSEMBLED
SHAKER WHITE BIRCH	

WALL HEIGHT

CROWN MOLDING

30" H	1 1/2"
36" H	3"
42" H	4"
STAGGERED	SUB-CROWN
NONE	NONE

ACCESSORIES

HARDWARE

SCRIBE	POLYMER LAZY SUSAN
OUTSIDE CORNER MOLDING	WOOD LAZY SUSAN
BASE MOLDING TRIM	ROLL OUT TRAYS
QUARTER ROUND MOLDING	TRAY DIVIDER
LIGHT RAIL	TILT-OUT TRAYS
VALANCE	DOOR MOUNT SPICE RACK
CORBELS	WALL THREE TIER PULL-OUT
ISLAND POSTS	BASE THREE TIER PULL-OUT
REFRIGERATOR PANEL	MIXER LIFT
DISHWASHER PANEL	BASE UTENSIL PULL-OUT
BAR BACK PANEL	BASE KNIFE BLOCK PULL-OUT
veneer panel	DOUBLE WASTE PULL-OUT
BEAD BOARD (WINTER HAVEN)	SOFT-CLOSE WASTE PULL-OUT
	HEAVY DUTY WASTE PULL-OUT

PROJECT INFORMATION

# OF UNITS	
# OF DIFFERENT LAYOUTS	

LAYOUT REQUIREMENT

WALL LOCATIONS & DIMENSIONS

DOOR & WINDOW MEASUREMENTS & LOCATIONS

ELECTRICAL, GAS & PLUMBING LOCATIONS

CEILING HEIGHT & SOFFIT DETAILS

LAYOUT INFORMATION

ESTIMATE ONLY

DRAW AS IS

MIDWEST DESIGNER TO CREATE LAYOUT

APPLIANCES

DIMENSIONS

SINK	
FARM SINK	
DISHWASHER	
FRIDGE	
RANGE	
COOKTOP	
SINGLE WALL OVEN	
DOUBLE WALL OVEN	
MICRO/OVEN COMBO	
COUNTERTOP MICRO	
OVER-THE-RANGE MICRO	
BUILT-IN MICRO	
UNDER CAB HOOD	
DECORATIVE HOOD	

CEILING HEIGHT:

DELIVERY OPTIONS

WILL CALL

DELIVERY

NOTE: Residential deliveries not available. Dealer must have receiving dock and fork lift to receive cabinet delivery.

NOTES:

PLEASE SEE SECOND PAGE FOR DRAWING INSTRUCTIONS



MIDWEST CABINET DESIGN

Email: cabinetdesign@midwestfloors.com

Phone: (801) 975-6125 Fax: (801) 990-6580

MEASURE GUIDE FOR CABINETS

1. Draw the basic wall formation of the space cabinets are to be placed.
2. Measure floor to ceiling height in 2-3 locations. Note the shortest distance. (A)
3. Measure all walls corner to corner. (B)
4. Measure and locate on drawing all windows, doors, obstacles and openings. Include the trim in the measurement.
Be sure to measure and note the dimension to the left and right of the opening. (C)
5. Measure to and indicate the location of water lines for sink and gas or electric for stove. (D)
6. Provide width and height of refrigerator. If using specialty/nonstandard appliances, please provide sizes. (E)

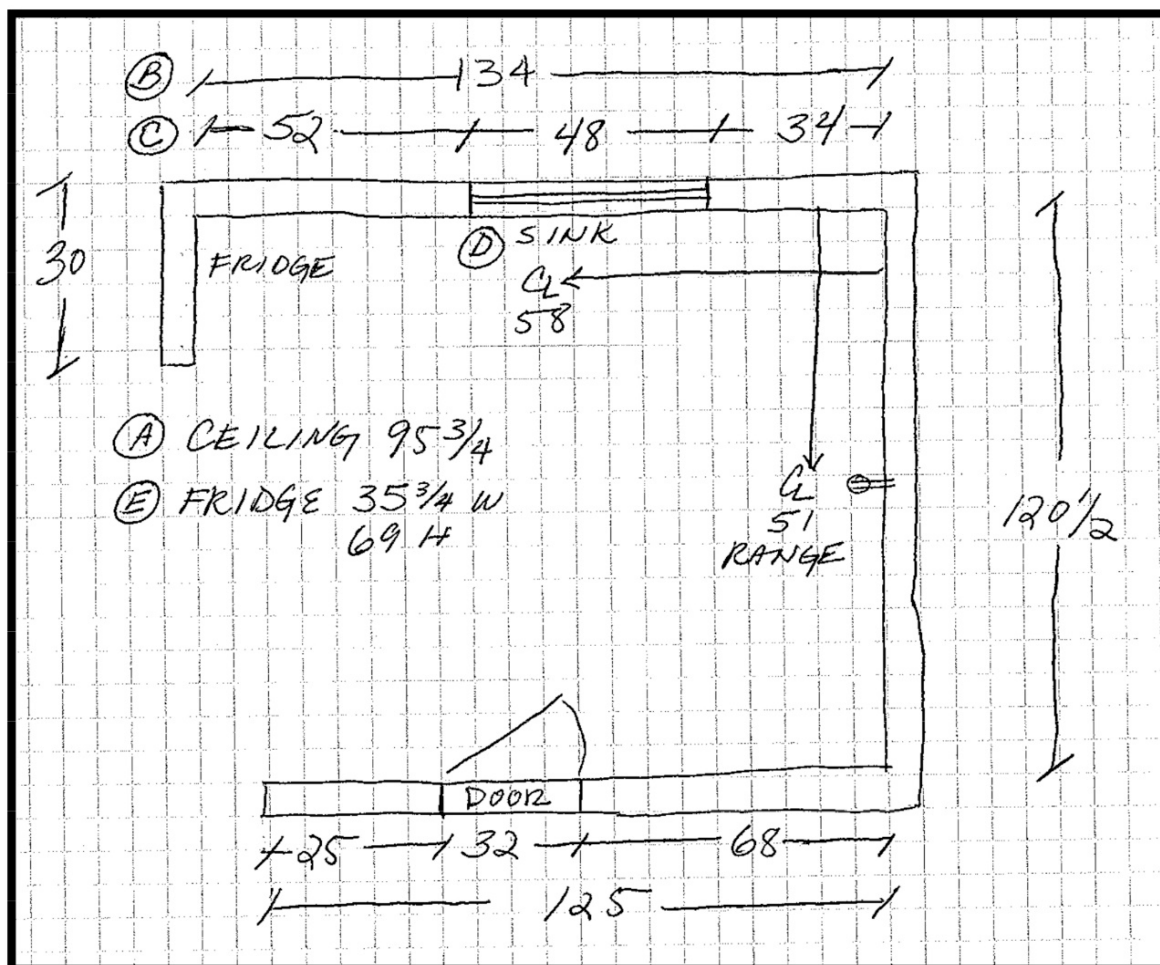

7. If your final drawings are in a digital format, they may be attached to the email when the Design Form is submitted or can be directly emailed to cabinetdesign@midwestfloors.com. If the drawings are not in a digital format, they can be faxed to Midwest Cabinet Design at **801-990-6580**.